

INSTALLATION - new remodel

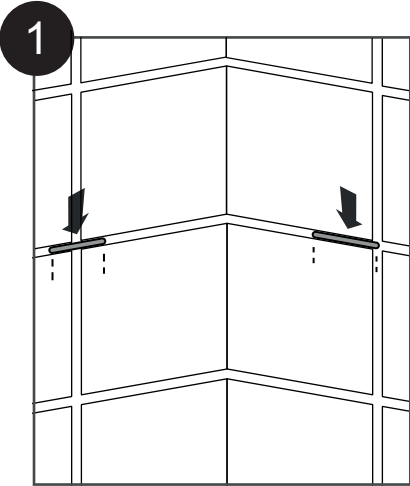

After completing tile installation, place 1/2" long spacers into install tab locations.

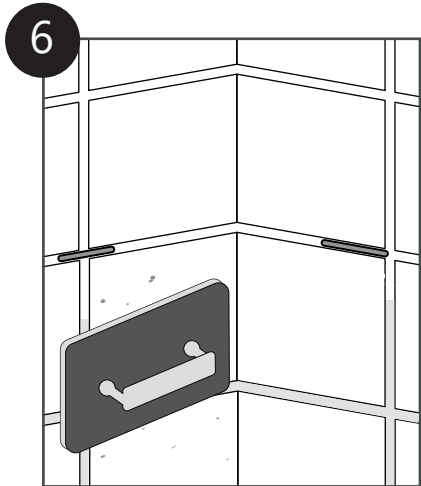

FRW/BSD0000000 0
 B00W/BSD0000000
 BRW0

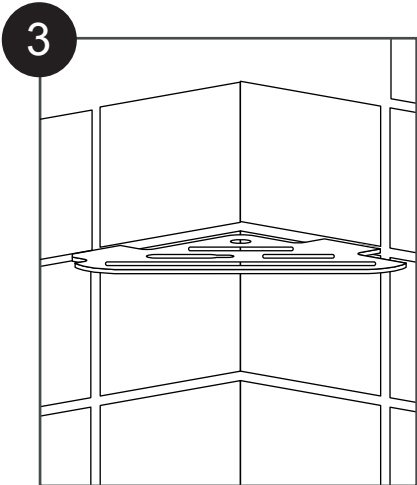

You can adjust the gap behind the shelf by pushing the shelf into the grout line gap, but ensure it is inserted at least 1/4".

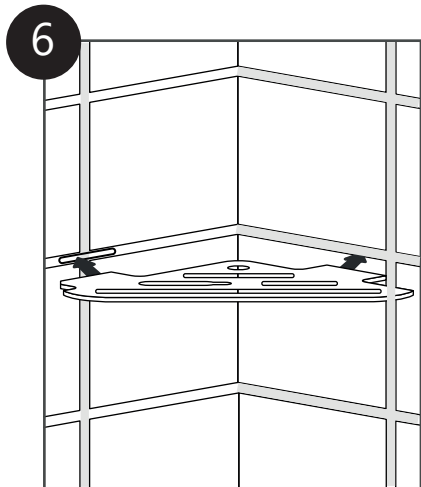

- Insert install legs into notches
- Be sure to insert the right leg first

CARE & CLEANING

General Care

All the Redblock products are constructed out of sheet stainless steel, so you must treat them with the same care as any other stainless steel appliance in your home (like your fridge, dishwasher, etc).

As you are probably already aware, stainless steel will scratch if you drag anything abrasive across its surface. Most of you will have a clear example of this just by looking at your kitchen sink (also made of stainless steel).

Both brushed and Polished stainless steel finishes are vulnerable in this way.

To avoid this problem, you should simply avoid placing anything hard and rough (like unglazed ceramics, or rough metal objects, etc.) on any stainless steel surface.

Cleaning

To clean any stainless steel surface, your first step should always be a bit of scrubbing with warm water and a clean microfiber rag. If this doesn't do the trick, a mild liquid dish detergent can be used. To avoid scratching, you should always wipe in the direction of the grain (direction of striations).

To remove fingerprints, or any stains from oil-based skin care products, or if you simply want to brighten up the surface, we recommend a solution of *OxiClean be used.

Completely dissolve the powdered OxiClean into a spray bottle (read the Oxiclean box for directions on hard surface cleaning). Apply liberally, a few applications, over all surfaces, waiting a few minutes between applications. Rinse thoroughly.

If there's any soap scum left after rinsing, use a sponge or micro-fibre rag to carefully remove any remaining scum. And remember to always wipe in the direction of the grain (direction of striations).

If you prefer to use a cleaning product other than OxiClean, you can use window cleaning spray, pure isopropyl alcohol or acetone.

Important Note about Chloride based Cleaners

Most of you may not know what a "chloride based cleaner" is, but you will all be familiar with the most common one, household bleach. Bleach is used routinely in consumer and commercial shower cleaning products because it's a cheap & effective cleaner that also kills bacteria and viruses.

But what many people don't know is that bleach is corrosive to metals (including shower fixtures made of chrome, nickel, stainless steel, etc.) and a strong oxidizing agent, which means it can cause metal to rust, and tile & grout to deteriorate with prolonged exposure.

A properly diluted bleach solution (or shower cleaning product) can still be a safe and effective shower tile, grout and fixture cleaner but only if it's promptly and thoroughly rinsed away after cleaning. In other words, brief exposure is OK but you must be aware that longer exposure increases the risk of oxidative damage to your metal fixtures, tile and grout.

*OxiClean in this form is also very effective as a general shower and bathroom cleaner. We at Redblock use it regularly to clean everything from shower tile and grout to patio furniture.

*OxiClean is a trademark of Church & Dwight Co., Inc.

RedblockTM
INDUSTRIES LLP