

# rb3 SHOWER CORNER SHELF INSTALLATION MANUAL

SCS-B

# TECHNICAL DRAWINGS

SCS-B

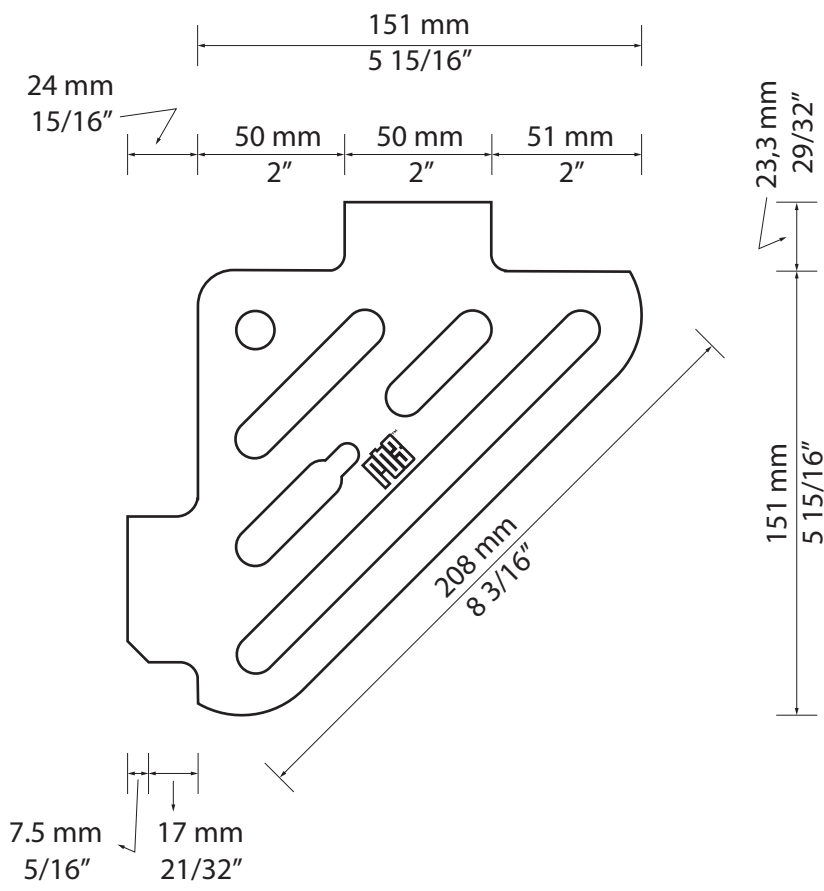

# INSTALLATION

---

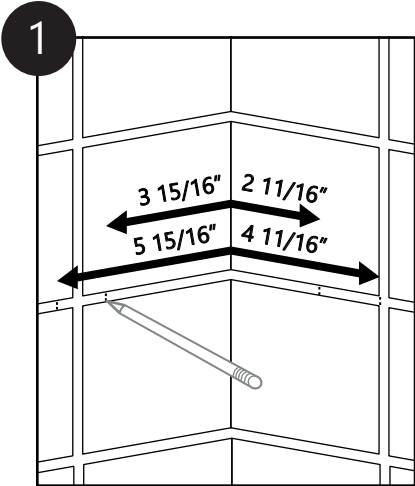

- Mark out two, 2" wide notches onto the grout line

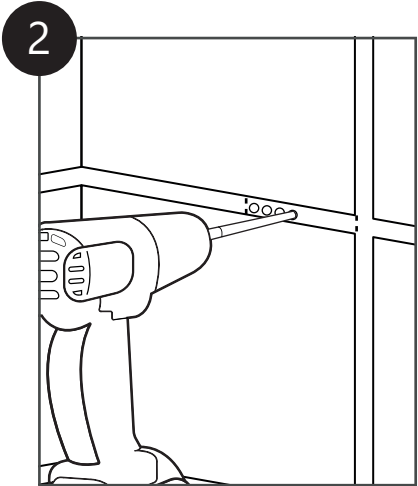

- Pre-drill 1/8" pilot holes to 1/4" depth between the two marks

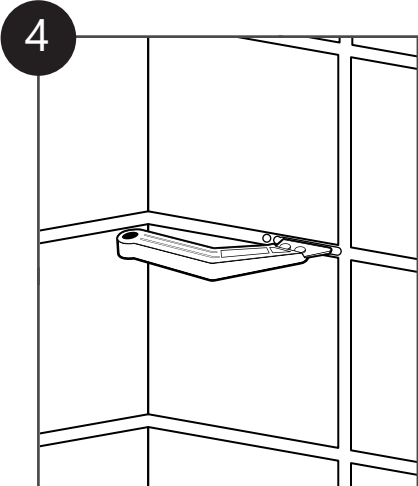
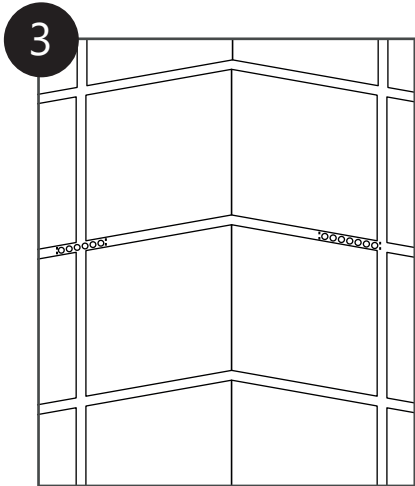

- Remove grout with grout removal tool
- Be careful not to damage membrane
- Clean notches thoroughly

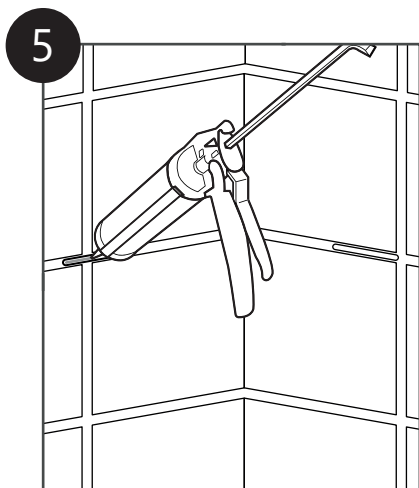

- After cleaning thoroughly, apply a bead of silicon into each notch.

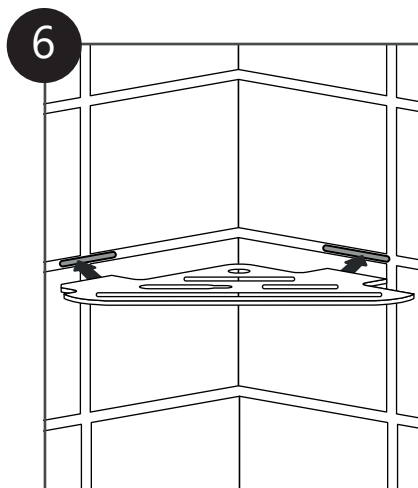

- Insert install legs into notches
- Be sure to insert the right leg first

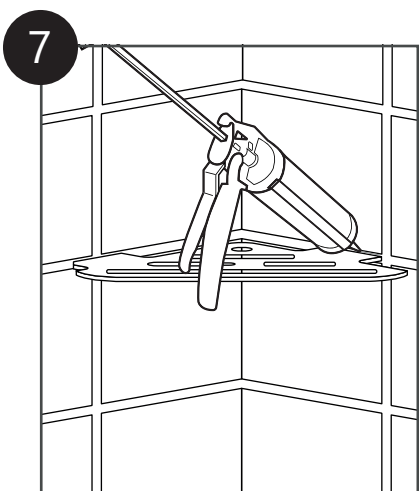

- Apply silicon around each installation leg

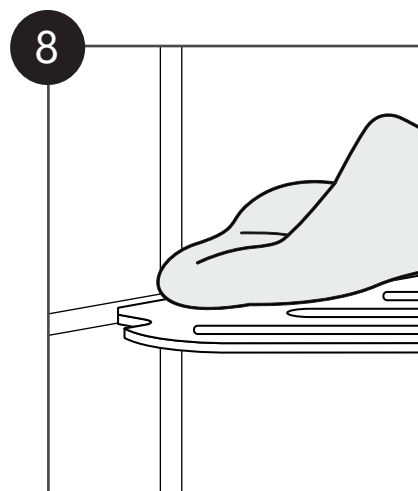

- Wipe away excess silicon
- Clean silicon residue with denatured alcohol



---

**CAUTION: PLEASE DO NOT USE ANY CLEANER THAT CONTAINS CHLORINE BLEACH** or any chlorinates.

Chlorine bleach can damage stainless steel and all other metal surfaces over time.

If you insist on using a chlorine bleach containing cleaner in your shower, try to avoid the niche and/ or shelf surfaces and promptly remove any residue that may end up on these surfaces.

We recommend that you use only non-abrasive cleansers for cleaning our products. The first cleaning step should always be with warm water, a clean rag (or sponge), and a little bit of scrubbing. A mild liquid dish detergent can also be used (as long as it does not contain chlorine bleach – see above). To reduce the chance of scratching, take care to wipe in the direction of the grain (direction of SS striations).

Another option would be \*OxiClean powder dissolved in water. If you would like more details on this or other cleaning options, please visit our [Stainless Steel Cleaning Page](#).

\* OxiClean is a registered trademark of Church & Dwight Co., Inc.

